



**Pump specifications:**

Type.....BV100 D240  
 Max. flow ..... 150 m<sup>3</sup>/hour (660 US GPM)  
 Max. pressure ..... 17 mwc (56 ft.)  
 Connections..... DN 100 (4")  
 Solids handling ..... 86 mm (3.38")  
 Impeller type ..... Open impeller  
 Priming system ..... BBA MP100  
 Engine ..... Hatz 2M41  
 Canopy ..... E12-25  
 Weight (net) ..... 2100 kg (4620 lb)  
 Sound level..... Approx. 60 dB (A) at 10m

**FEATURES**

**BV auto prime pump**

The BV range of pumps has been designed with a clear focus on reliability and durability. Featuring a 100% mechanical priming system, the BV series pumps quickly prime and re-prime, even from dry conditions. The heavy build style of both pump and frame make the BV range perfect for use in the strenuous drilling market.

**World-class performance**

The BV range is built to be deployed on the most demanding drilling and bentonite applications. Using high efficiency pumps and state-of-the-art diesel engines, the pumps offer maximum performance at minimal cost, fully in-sync with the company philosophy of "Lowest cost of ownership".

**Key features**

- Steel welded materials offers high wear resistance
- Basic mechanical pump concept
- MP100 oil-spill free priming system
- Easy clean floating box on the suction spool
- Large inspection covers for easy access
- Robust design

**Complete package designed & built by BBA Pumps**

- Complete in-house design & production
- Over 60 years of experience in the market
- Complete testing facility in-house
- Contemporary & functional design
- Durable & eco-friendly materials
- Custom builds available

**After sales service & product support**

- Single supplier for parts, spares & accessories
- Dedicated customer help-desk (24h service)
- Dedicated service department in-house
- Global parts distribution network
- Optional global on-site servicing available
- Extensive training options available (technical & commercial), on-site or in-house



**PERFORMANCE CURVES (1500 RPM)**

Density: 998.3 kg/m<sup>3</sup>

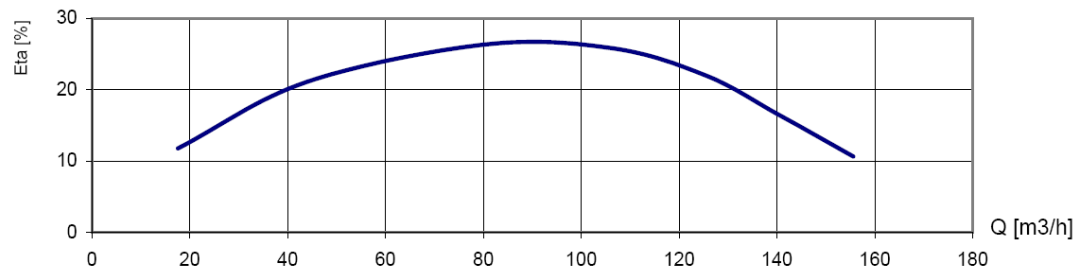
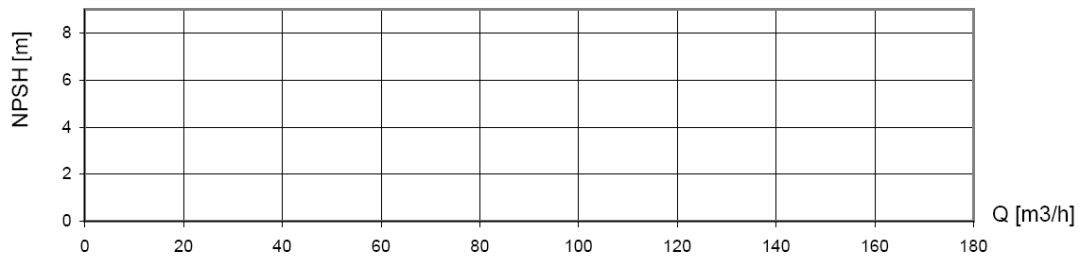
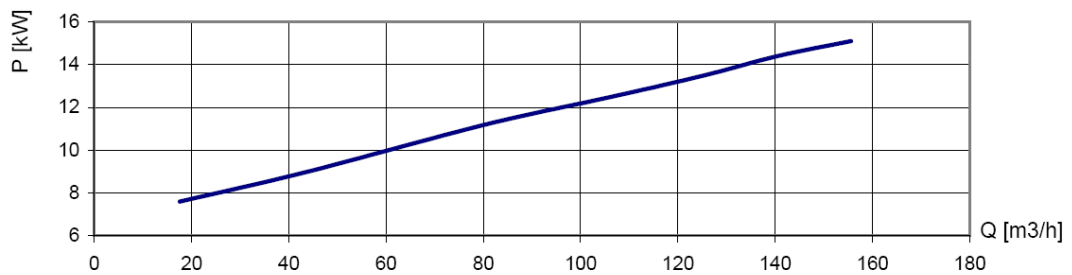
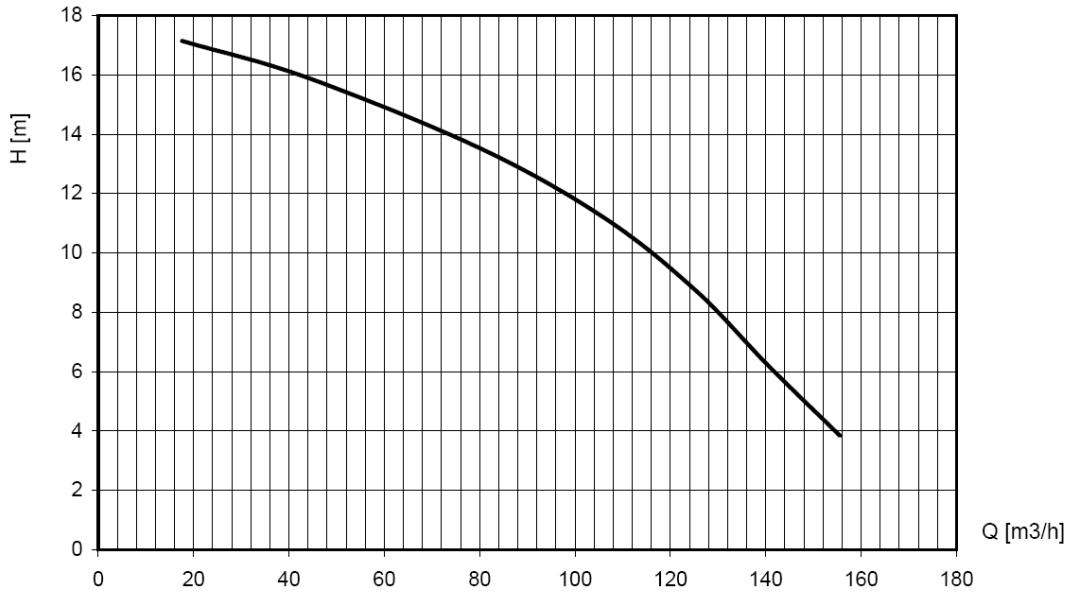

**STANDARD TECHNICAL SPECIFICATIONS**

**BBA auto prime pump**

Pump type.....	BV100 D240
Max. flow.....	150 m <sup>3</sup> /hour (660 US GPM)
Max. head.....	17 mwc (56 feet)
Impeller type.....	Open impeller
Solids handling.....	86 mm (3.38 inch)
Pump casing.....	Steel DIN 1.0036
Impeller.....	Steel DIN 1.0036
Wear plate.....	Steel DIN 1.0036
Pump shaft.....	Steel DIN 1.1191
Shaft seal.....	Mechanical seal 60 mm (2.36 inch)
Seal faces.....	Tungsten/Tungsten
O-ring.....	Viton

**BBA priming system**

Pump type.....	BBA MP100 Diaphragm pump
Air handling capacity.....	100 m <sup>3</sup> /h (59 CFM)
Max. vacuum.....	8.5 m (29 inHg)
Drive.....	Toothed belt (continuous drive)
Float box.....	“Easy clean” hot dip galvanised
Non return valve.....	Steel DIN 1.0036
Check valve disc.....	Buna-N

**Engine**

Engine brand.....	Hatz
Engine type.....	2M41
Flywheel power.....	15 kW (20 Hp)
Max. engine speed.....	1500 RPM
Fuel consumption.....	223 g/kWh
Displacement.....	1.716 l
Number of cylinders.....	2
Cooling system.....	Air cooled
Starting method.....	Electric start
Exhaust emission EU.....	Stage IIIA
Exhaust emission US.....	Tier 4i (EPA on demand)

**BBA control panel LC04**

- Auto start/stop system
- Two float switches included (10 m cable)
- Switch Manual-0-Auto
- Hour counter
- Warning light “oil temperature”
- Warning light “alternator”

**Fuel system**

- Composite fuel tank 300 L (80 US Gallon)
- Fuel tank cap Ø 60 mm (2.5 inch)
- Mechanical fuel injection system



**Electrical system & safety features**

- Nominal voltage 12 Volt
- Premium quality battery 92 amp.
- Low oil pressure shut down

**CANOPY E12-25**

**BBA super silent canopy**

Canopy type.....	E12-25
Dimensions L x W x H .....	2500 x 1250 x 1900 mm
Dimensions L x W x H .....	98.5 x 49.2 x 75 inch
Basic frame .....	Hot dip galvanised
Panels .....	Powder coated
Doors .....	4 easy-access doors (lockable)
Fuel tank .....	PE net 300 ltr (80 US Gallon)
Fuel tank autonomy .....	80 hours
Fuel tank cap .....	60 mm (2.5 inch)
Forklift pockets.....	Fitted with 2 forklift pockets
Lifting point .....	Fitted with single lifting point
Oil drain pump .....	Drain pump for engine oil installed (hand pump)
Connections .....	Please consult "auxiliary items"
Exhaust system .....	Fully integrated in canopy
Documentation box.....	BBA user manual
Additional .....	Fitted with oil-water separator



**BBA E-slide® system**

The E12-25 canopy has been fitted with the BBA E-slide® system, meaning that the pump and the diesel engine are mounted on a sub-frame which can be removed quickly from the canopy. This facilitates cleaning of the canopy and also allows for quick and easy inspections and preventative maintenance work on the engine and pump should this be required.

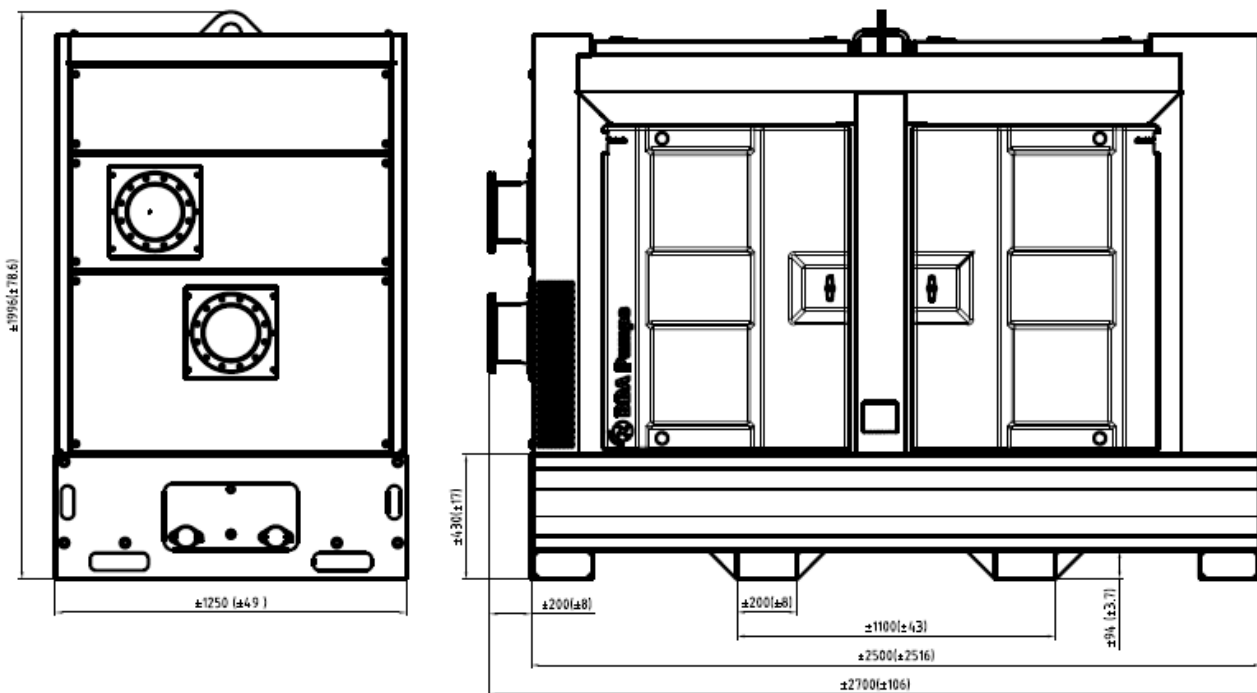

Actual dimensions (in mm & inches) may vary depending on selected quick couplings.



**Open impeller**  
Steel welded high abrasion resistant impeller and wear plate.



**Double vacuum pump**  
Diaphragm pump, air-cooled, water-resistant and oil-spillage free. Air capacity of 100 m<sup>3</sup> per hour.



**Easy inspection**  
Oil glasses, drain valves and fill plugs all easily accessible.



**Easy clean floating box**  
Fully galvanised floating box with stainless steel floater and easy accessible.



**Large inspection covers**  
Easy access to suction spool, impeller and non-return valve.



**Interchangeable parts**  
Modular construction to ensure minimal spare part stock levels.

Pictures used are for illustration purposes only.